

Numatic International Spare Parts

Model No: NDS 570A ASSEMBLY

NB: FOR WIRING SEE DRAWING: DRW-9937, DRW-9938

234859
DRAWING: DRW-7157 ISS: A03
09/02/2012

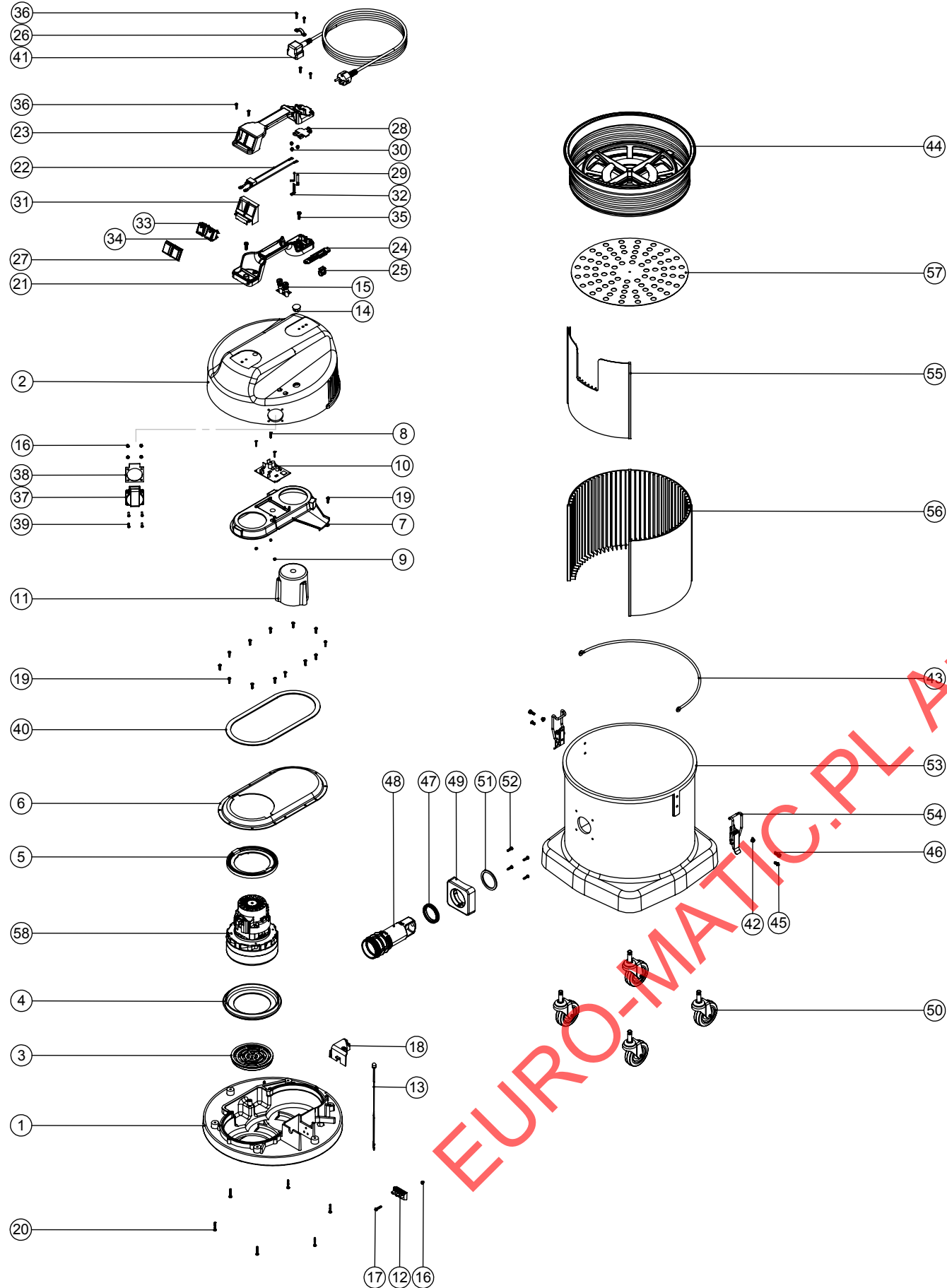

Numatic International Spare Parts

Model No: NDS 570A ASSEMBLY

ITEM:	PART No:	DESCRIPTION:	COMMENTS:
1	323008	REAR MOTOR REPLACEMENT SPACER	
2	323003	NDD COVER PROCESSED FOR 230V EURO PTO SOCKET / 2 FUSE HOLDERS + LOW FLO LED	
3	206010	FAN GUARD	
4	202005	MOTOR BOTTOM GASKET	
5	227925	TOP MOTOR GASKET (LAMB BYPASS MOTOR)	
6	225177	NDS (FRONT MOTOR) SIMPLEX TOP MOTOR HOUSING	
7	237067	DUPLEX AIR SEPERATOR (FINE DUST SYSTEM)	
8	219038	M3.16MM LG.SLOT.SCREW.Z/PL	
9	219070	NUT.M3.NYLON INSERT.Z/PL	
10	230148	DUPLEX AUTO CONTROL PCB. 100-240VAC. 50/60HZ	
11	237278	REAR MOTOR REPLACEMENT SPACER	
12	208263	TERMINAL BLOCK REF 2012	
13	321555	LOW FLOW LED LOOM	
14	220967	WINDOW PLUG (TYPE WP 750) HEYCO REF: 438 1309	
15	221420	FUSE HOLDER (REF HTB-38M)	
16	219083	NUT.M4.NYLON INSERT.Z/PL	
17	21990V	M4.20MM LG.POZI-PAN.SCREW.Z/PL	
18	237069	LED HOLDER (DUSTCARE SYSTEM)	
19	219370	NO8.5/8" LG.POZI-PAN.SCREW.STAINLESS STEEL.PLASTITE	
20	219369	NO8.1/2 INCH LG.POZI-PAN.SCREW.STAINLESS STEEL.PLASTITE	
21	320835	HANDLE BASE MOULDING + INSERTS (3 CORE)	
22	230151	SUPPRESSOR ASSEMBLY(NVP/2 WIRE)	
23	227620	HANDLE COVER 16AMP 3PIN 2 SWITCH	
24	227636	STRAIN RELIEF ARM (SOCKET)	
25	227637	CABLE CLIP (SOCKET)	
26	216290	CABLE CLAMP 16A	
27	206573	SWITCH COVER (PLUG HANDLE)	
28	227631	TERMINAL COVER & CLAMP 3PIN	
29	206562	CONTACT PIN	
30	219090	M4.8MM LG.POZI-PAN.SCREW.Z/PL.SEM.	
31	227629	SWITCH MOUNTING BRACKET 2 SWITCH	
32	206563	EARTH CONTACT PIN	
33	220552	RED ROCKER SWITCH (WHITE PRINT)	
34	220582	GREEN ROCKER SWITCH (0-1) C1 550VQ	
35	219546	M5.20MM LG.POZI-PAN.SCREW.Z/PL.SEM	
36	219107	NO6.5/8 INCH LG.POZI-PAN.SCREW.Z/PL.PLASTITE	
37	230162	EURO SOCKET (A1461000 EUROPE)	
	230164	SWISS SOCKET (A1461006 SWISS)	
38	230166	SOCKET GASKET	
39	219407	M4 X 16MM LONG POZI PAN COUNTERSUNK SCREW	
40	202012	GASKET	
41	236143	10.0MT X 1.5MM X 3 CORE YELLOW CABLE (SOCKET + PLUG) EURO	
	236019	10.0MT X 1.5MM X 3 CORE CABLE (SOCKET + PLUG) SWISS	
42	208025	SPACER BUCKET HANDLE WV575/750	
43	418512	BUCKET HANDLE CRANKED PNT BLACK	
44	604411	MICROTEX FILTER FOR 356MM MACHINE	
45	219330	M5.12MM LG.POZI-PAN.SCREW.Z/PL.C/SUNK	
46	219045	M5.16MM LG.POZI-PAN.SCREW.Z/PL.SEM	
47	202102	BAYONET SEAL	
48	237342	BAG CONNECTOR TUBE	
49	237343	BAG CONNECTOR FRONT	
50	204060	3 INCH STEM FITTING CASTOR	
51	202027	HOSE FLANGE GASKET	
52	219105	NO8.5/8 INCH LG.POZI-PAN.SCREW.Z/PL.PLASTITE	
53	325132	572 GREY DRUM PUNCH & INSERT	
54	206135	TOGGLE FASTENER 30-1665 MSBL	
55	308028	DRUM LINER (FOR ASSEMBLY VIEW ONLY)	
56	237048	DRUM LINER (FOR ASSEMBLY VIEW)	
57	401447	DRUM BASE (FINE DUST VACUUM CLEANER) PAINTED GREY	
58	205443	230V 2 STAGE D.I BYPASS ACUSTEK MOTOR (BL21104T) (MARKED 230V) TCO	



WARNING
Seek guidance from Numatic team before use.
Technical information supplied as guidance for use by suitably qualified personnel only.
Numatic International Limited accepts no liability for misuse or negligence.

